

Toolboxes & Watertanks





Black Powder Coated Steel Toolboxes Fitted With In-board Seals TB500BP, TB600BP, TB800BP, TB1000BP, TB1200BP, TB1450BP

MATERIAL

Steel

FINISH

Black powder coated

FEATURES

1.5 mm material thickness
Dust Seal
Galvanised
Stainless Steel Drop-T Locks

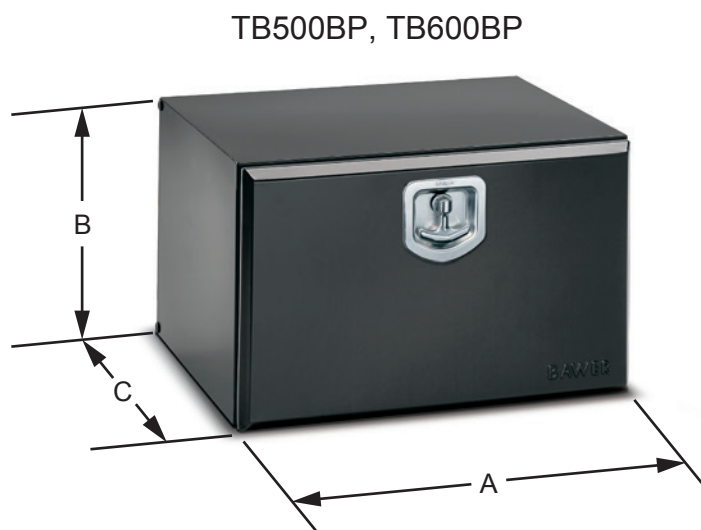

TB500BP

A = 500
B = 350
C = 400
1 × Lock
Weight 12.21kg

TB600BP

A = 600
B = 400
C = 500
1 × Lock
Weight 15.21kg

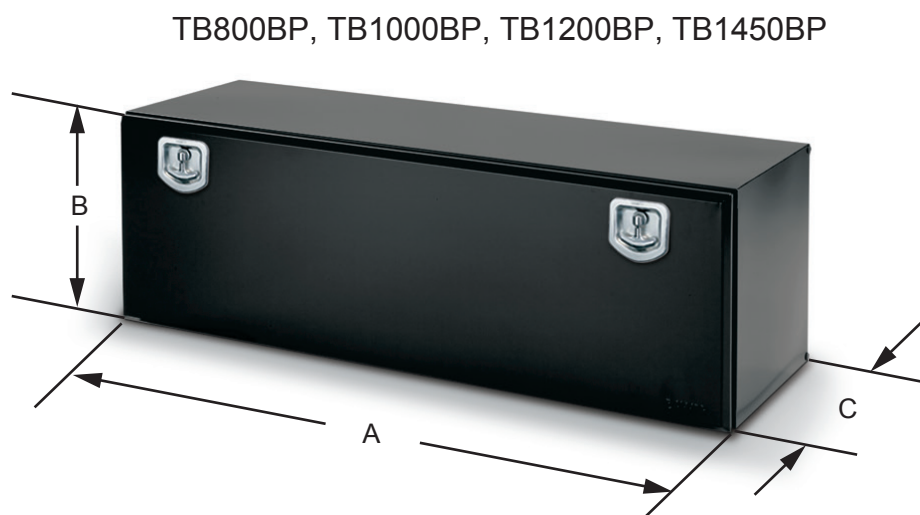

TB800BP

A = 800
B = 500
C = 500
2 × Locks
Weight 24.35kg

TB1000BP

A = 1000
B = 500
C = 500
2 × Locks
Weight 30.11kg

TB1200BP

A = 1200
B = 500
C = 500
2 × Locks
Weight 34.81kg

TB1450BP

A = 1450
B = 500
C = 500
2 × Locks
Weight 40.81kg

Toolbox Lid Supporting Lanyard Kit

LAN15

Suits TB500BP

LAN2035

Suits TB600BP TB800BP TB1000BP TB1200BP + TB1450BP

Toolbox Undertray TBUTBPRH, TBUTBPLH

MATERIAL

Steel

FINISH

Black powder coated

FEATURES

TBUTBPRH Right Handed

TBUTBPLH Left Handed

High Quality T-Lock
Tested for mechanical
resistance and waterproofing.
TIG welding qualified process
according to UNI EN ISO 15614-1
Can be mounted under tie-down rails.
Alignment pin to aid closing.

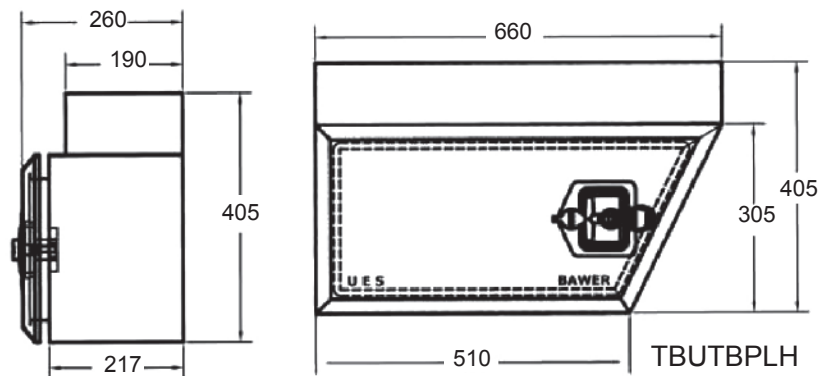

Multibox Toolbox TB1200BP-3

MATERIAL

TB1200BP-3 Steel

FINISH

TB1200BP-3 Black Powder Coated

FEATURES

Thickness 1.5mm
Includes 25L water tank, 800mm toolbox,
and separate fire extinguisher housing

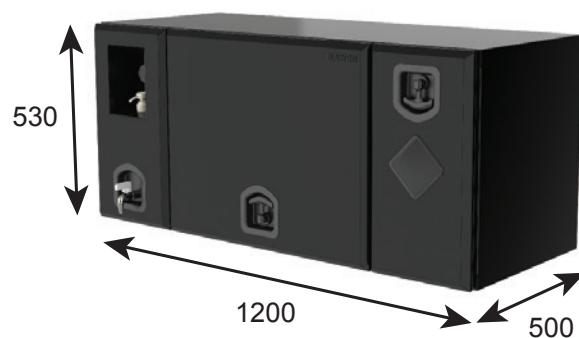

Toolbox Above Tray TB1210W-2, TB1500W-2

MATERIAL

Galvanized Steel

FINISH

White

FEATURES

1.5mm Thick

Euroinox V9964 Lock

Brackets on all three doors to allow operators to fit own padlock

TB1210W-2 - H=750mm, L=1210mm, D=600mm

TB1500W-2 - H=750mm, L=1500mm, D=600mm



Toolbox Above Tray TB1210W

MATERIAL

Galvanized Steel

FINISH

White

FEATURES

1.5mm Thick

2x Euroinox V9964 Lock

L=1270mm, x H=740mm, x D=580mm



Stainless Steel Toolboxes Fitted With In-board Seals

TB500SS, TB600SS, TB800SS, TB1000SS, TB1200SS

MATERIAL

Stainless Steel

FINISH

Polished lid

FEATURES

1.5 mm material thickness
With High Quality Drop-T Handles.
Welding codes
Tested for mechanical resistance
and waterproofing.
TIG welding qualified process
according to UNI EN ISO 15614-1

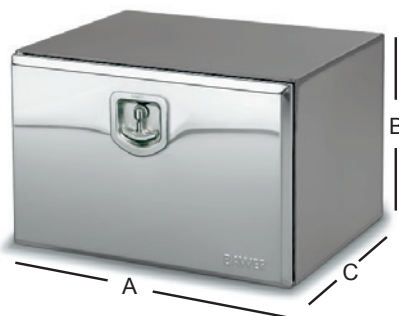

TB500SS, TB600SS



TB800SS, TB1000SS, TB1200SS

TB500SS

A = 500
B = 350
C = 400
1 x Handle
Weight 12.21kg

TB600SS

A = 600
B = 400
C = 500
1 x Handle
Weight 15.21kg

TB800SS

A = 800
B = 500
C = 500
2 x Handles
Weight 24.35kg

TB1000SS

A = 1000
B = 500
C = 500
2 x Handles
Weight 30.11kg

TB1200SS

A = 1200
B = 500
C = 500
2 x Handles
Weight 34.81kg

Toolbox Lid Supporting Lanyard Kit

LAN2015	Suits TB500SS
LAN2035	Suits TB600SS TB800SS TB1000SS TB1200SS

Mounting Brackets for Toolboxes TBBKT3

MATERIAL

Steel

FINISH

Black Powder Coated

FEATURES

5mm thick Steel
Angle Iron: 50mm x 50mm
Flat Support Plate: 50mm

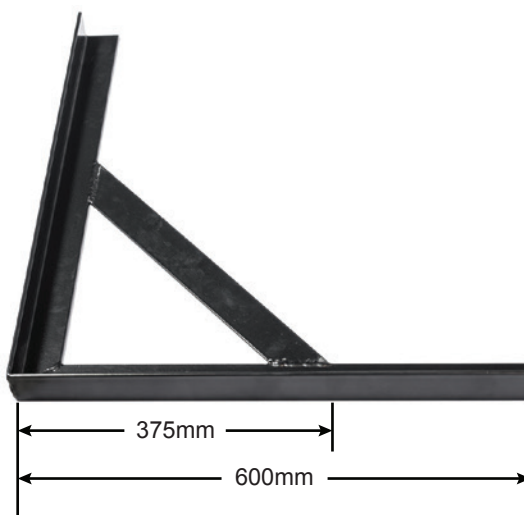

Polypropylene Toolbox TB500PL

MATERIAL

Injection moulded polypropylene

FINISH

Raw

FEATURES

External dimensions (mm): 500x350x400

Weight (kg): 3.3

Optimal load (kg): 35

Capacity (lt): 41

Quantity per pallet (n°): 36

Pallets dimensions (cm): 108x102x255

Pallet Weight (kg): 155

Nylon Handle

EPDM Seal

Stackable

Suits Mounting bracket TBBKT1

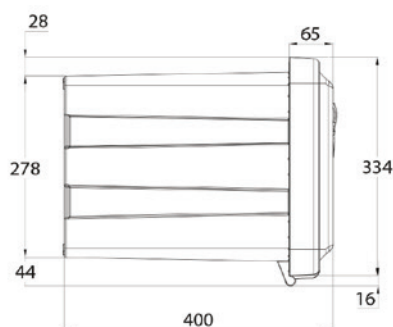
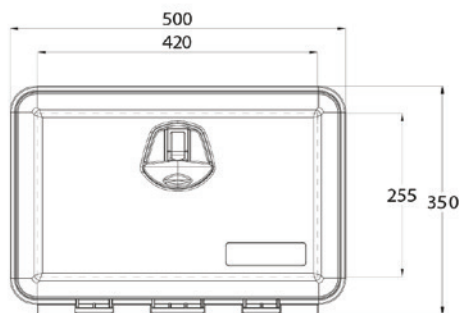

Polypropylene Toolbox TB600PL

MATERIAL

Injection moulded polypropylene

FINISH

Raw

FEATURES

External dimensions (mm): 600x415x460

Weight (kg): 4.9

Optimal load (kg): 45

Capacity (lt): 71.5

Quantity per pallet (n°): 25

Pallets dimensions (cm): 124x100x255

Pallet Weight (kg): 150

Nylon Handle

EPDM Seal

Stackable

Suits Mounting bracket TBBKT2

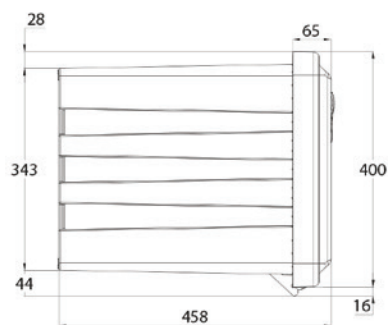
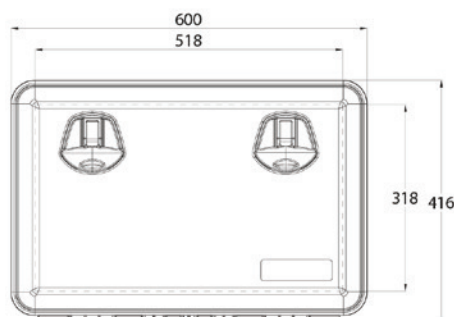

Polypropylene Toolbox TB750PL

MATERIAL

Injection moulded polypropylene

FINISH

Raw

FEATURES

External dimensions (mm): 750x350x450

Weight (kg): 5,20

Optimal load (kg): 45

Capacity (lt): 65

Quantity per pallet (n°): 15

Pallets dimensions (cm): 108x76x250

Pallet Weight (kg): 100

Nylon Handle

EPDM Seal

Stackable

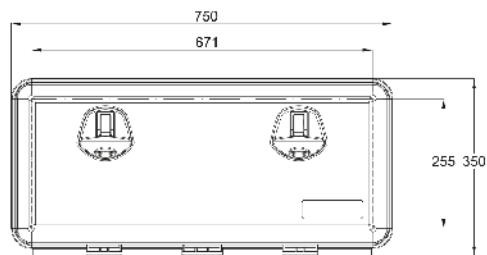

Suits Mounting bracket TBBKT2

Mounting Brackets for Polypropylene Toolboxes TBBKT1

MATERIAL

Steel

FINISH

Galvanised

FEATURES

For toolbox: 81102

Weight (kg): 1.50

Thickness (mm): 2.0

Maximum Load (kg): 150

Fasteners included

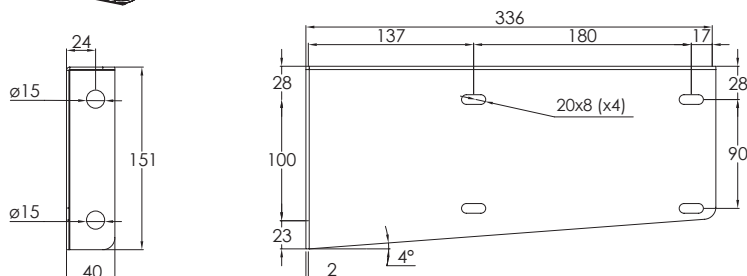
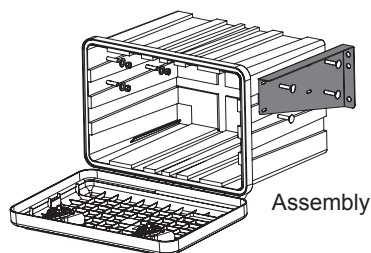

Mounting Brackets for Polypropylene Toolboxes TBBKT2

MATERIAL

Steel

FINISH

Galvanised

FEATURES

For toolbox: 81104, 88106

Weight (kg): 4.0

Thickness (mm): 3.0

Maximum Load (kg): 150

Fasteners included

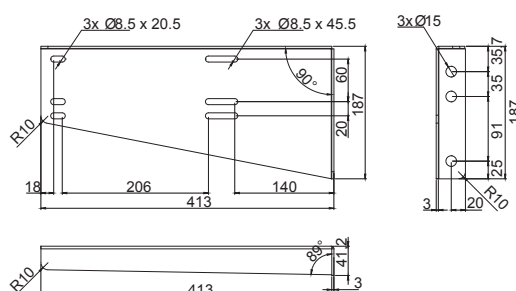
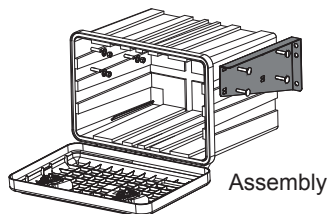

Polyethylene Water Tank 30L TK2520-1, WT30PBRO

MATERIAL

Polyethylene

FEATURES

- TK2520-1 Water Tank in black plastic.
- WT30PBRO Water Tank in black plastic with Soap Holder.
Capacity 30L
- WTSD2 Soap holder 250mL.
- WT30PBRO-1 Brackets.



Plastic Water Tank 30L WT30PBSQ

MATERIAL

Polyethylene

FEATURES

- Weight: 2.45kg
- Suits Bracket: WT30PBSQ-BKT

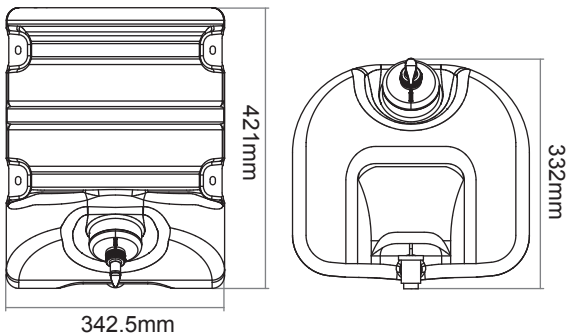

Plastic Water Tank Brackets WT30PBSQ-BKT

MATERIAL

Zinc Plated Steel

FEATURES

- Weight: 2 kg
- Suits water tank: WT30PBSQ



Assembled with
water tank WT30PBSQ

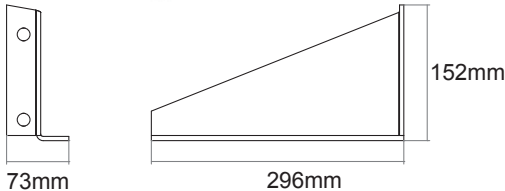

Polyethylene Water Tank 25L WT25PWRE-1

MATERIAL

Polyethylene

FEATURES

Plastic Handwash Unit 25L
without frame

WTCAP3 Cap

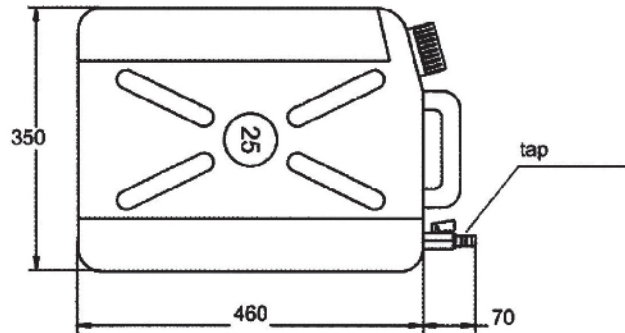

Polyethylene Water Tank 25L WT25PWRE-1-BKT

MATERIAL

Polyethylene

FEATURES

Plastic Handwash Unit 25L
with Zinc Plated Steel Frame

WTCAP3 Cap

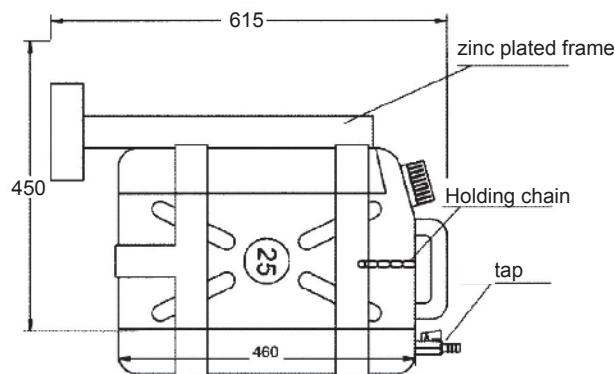







Call us
1300 00 1904
for further information

Polyethylene Water Tank WT15PBSQ

MATERIAL

Polyethylene

FEATURES

15 Litre Capacity
Soap dispenser (supplied)
Polyethylene walls - 6mm
Net weight 3kg
Manufactured from UV Stable,
food Grade polymer

SPARE PARTS

WTCAP1 - Inlet Cap
WTTAP1 - Outlet Tap
WTSD1 - Soap Dispenser

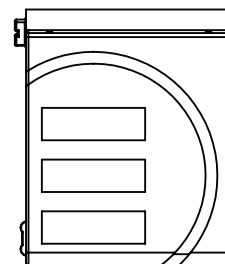
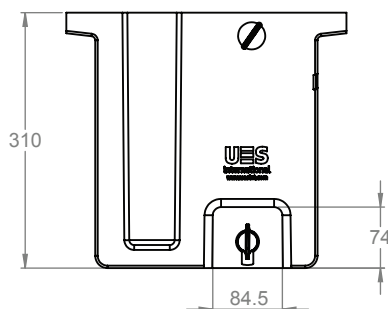
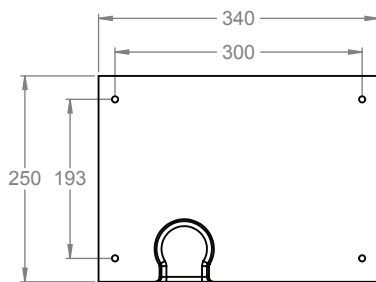

Polyethylene Water Tank WT23PBRE

MATERIAL

Polyethylene

FEATURES

23 Litre Capacity
oap dispenser (supplied)
Polyethylene walls - 6mm
Net weight 3kg
Manufactured from UV Stable,
food Grade polymer

SPARE PARTS

WTCAP1 - Inlet Cap
WTTAP1 - Outlet Tap
WTSD1 - Soap Dispenser

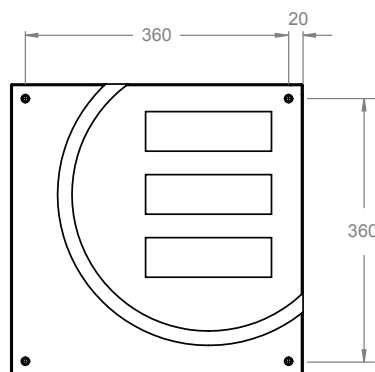
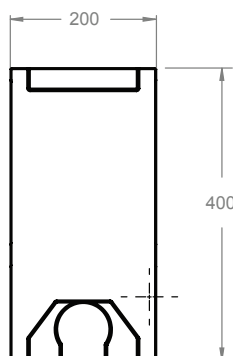
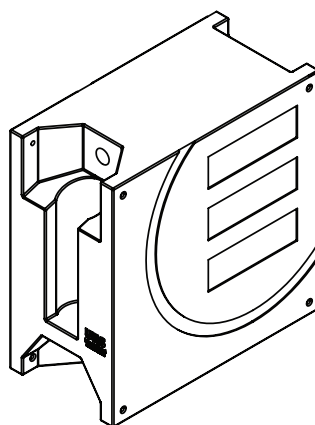

Polyethylene Water Tank WT30PBAN

MATERIAL

Polyethylene

FEATURES

30 Litre Capacity
 Soap dispenser (supplied)
 Polyethylene walls - 6mm
 Net weight 4.5kg
 Manufactured from UV Stable,
 food Grade polymer
SPARE PARTS
 WTCAP1 - Inlet Cap
 WTTAP1 - Outlet Tap
 WTSD1 - Soap Dispenser

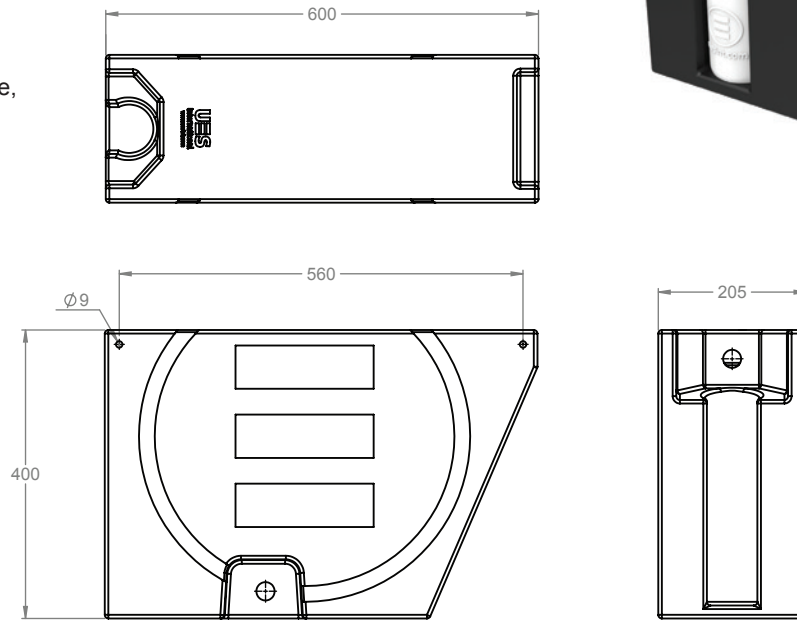

Polyethylene Water Tank WT60PBRO

MATERIAL

Polyethylene

FEATURES

60 Litre Capacity
 Soap dispenser (supplied)
 Polyethylene walls - 6mm
 Net weight 9kg
 Manufactured from UV Stable,
 food Grade polymer
SPARE PARTS
 WTCAP1 - Inlet Cap
 WTTAP1 - Outlet Tap
 WTSD1 - Soap Dispenser

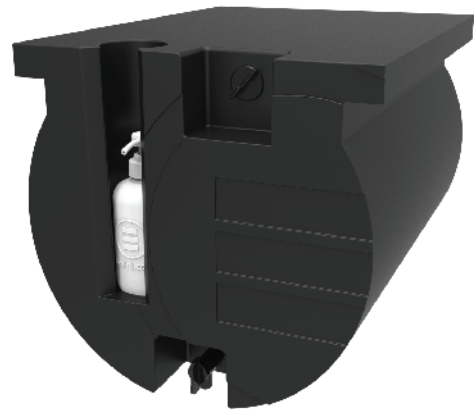
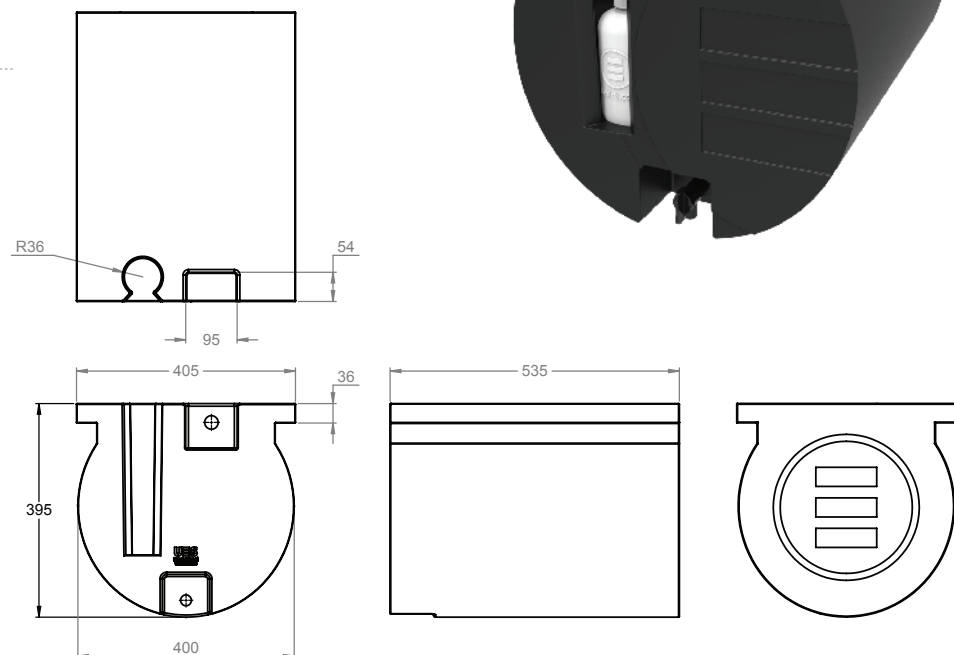

Stainless Steel Water Reservoir 25L WT25SSRE

MATERIAL

Stainless Steel

FINISH

Flowered Stainless Steel

FEATURES

25L Capacity

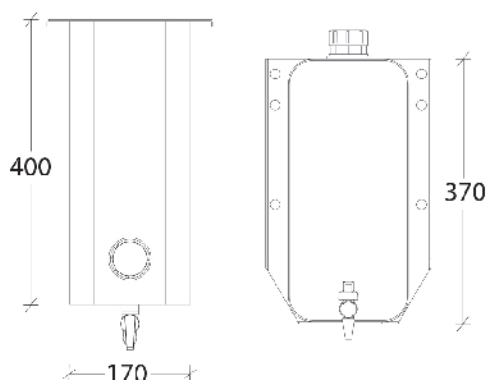

Water Reservoir Tank WT25SSOV-1

MATERIAL

Stainless Steel

FINISH

Flowered Stainless Steel

FEATURES

400mmL x 360mmW x 250mmH

Hand Wash Reservoir

25L Capacity

SPARE PARTS

WTTAP2 - Tap



Water Reservoir WT25SSRE-1

MATERIAL

Stainless Steel

FINISH

Flowered Stainless Steel

FEATURES

400L x 240W x 370H

Hand Wash Reservoir

25L Capacity

SPARE PARTS

WTTAP2 - TAP



Aluminium Water Tank 60L WT60ALRO

MATERIAL

Aluminium

FEATURES

60 Litre Capacity
Highly Polished
Easily mounted with 4 bolts

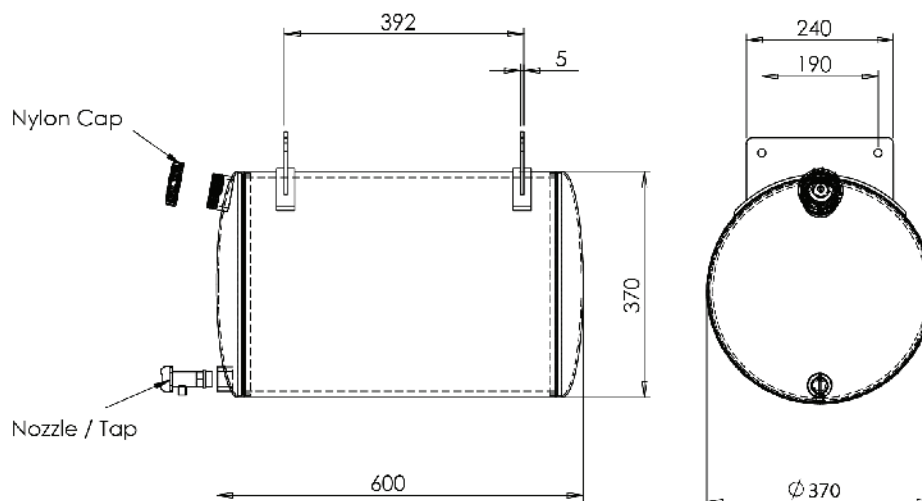

Trailer Hardware
Shop Online Now
www.uesint.com



TEL(AUS): 1300 00 1904 TEL(NZ): +64 (0)9 633 4019 www.uesint.com info@uesint.com
Showrooms in Sydney • Brisbane • Melbourne • Perth • Adelaide • Darwin • Nowra • Auckland